



Build It With



— Custom —

MUDROOM
BENCH



BUILD IT WITH BAIRD / MUDROOM BENCH

TOOLS NEEDED:

- Tape Measure
- Speed Square
- Framing Square
- Level
- Sandpaper
- Clamps
- Brad Nailer
- 18 Gauge 1-1/4" Brad Nails
- 18 Gauge 1-1/2" Brad Nails
- Drill
- Kreg 1-1/4" Screws
- Kreg Pocket-Hole Jig 720PRO
- Miter Saw
- Table Saw
- Compact Router
- Wood Glue





BUILD IT WITH BAIRD / MUDROOM BENCH

MATERIALS NEED			
Qty	Description	Material	T x W x L
2	Sides	Poplar	3/4" x 17 1/4" x 17"
1	Back	Plywood	3/4" x 41 1/4" x 16 1/2"
2	Dividers	Plywood	3/4" x 12 1/4" x 16 1/2"
1	Top	White Oak Character-Grade Plank	1" net x 19" x 44"

Step 1

Get started by laying out the base framework for the bench and drill together using 1 1/4" screws.

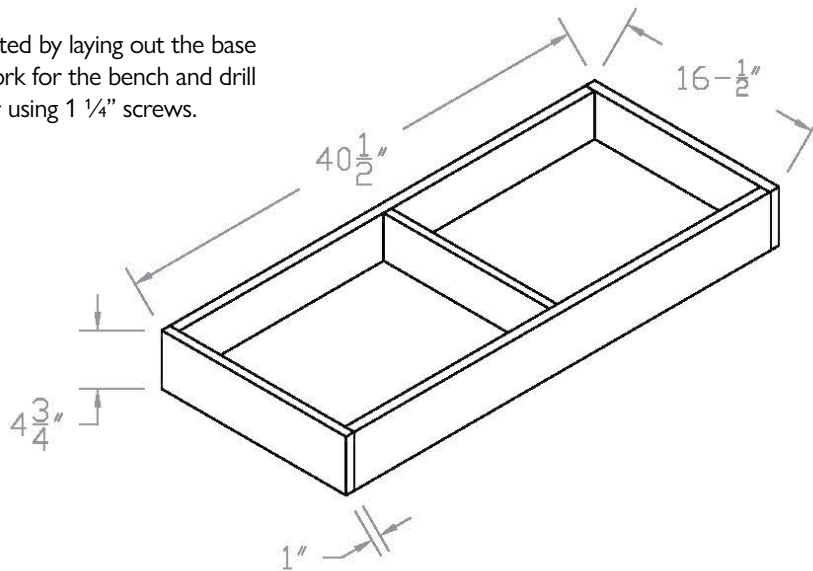

2x6 Framing Lumber
Ripped To 4-3/4" 11'+ Required

Step 2

Create 3/8" Deep dado joints in your plywood end panels, base structure and character-grade plank top. Dry-fit the pieces together with your plywood dividers to check your joints. Disassemble after ensuring all pieces are snug.

Apply wood glue to all joints and reassemble. Then, nail the pieces in place using a brad nailer with 1 1/2" nails.

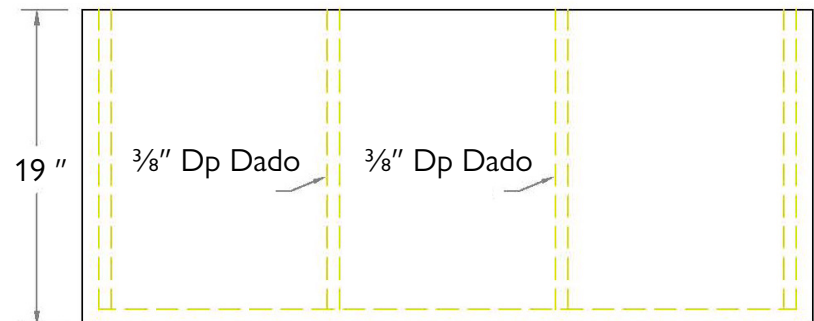



BUILD IT WITH BAIRD / MUDROOM BENCH

Step 3

Just as we did with the base unit, we'll create deep dado joints in the top structure to assemble the shelves and dividers. Dry-fit together all pieces to ensure they are snug.

Reassemble using glue in all joints then nail in place with a brand nailer using 1 1/2" nails.

MATERIALS NEEDED

Qty	Description	Material	T x W x L
2	Sides	Plywood	3/4" x 11 1/2" x 78"
2	Dividers	Plywood	3/4" x 10 3/4" x 15 1/4"
1	Top	Character Grade White Oak	3/4" x 41 1/4" x 11 1/2"
1	Bottom Shelf	Plywood	3/4" x 41 1/4" x 16 1/2"

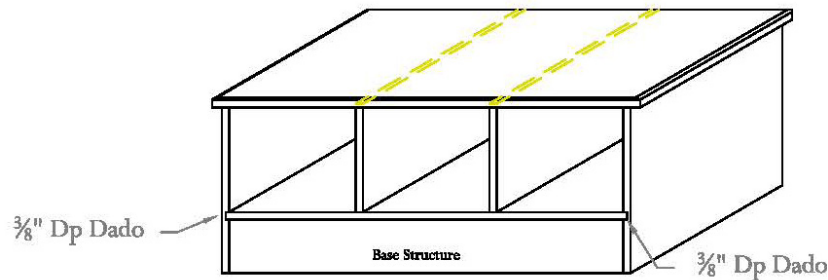

ISOMETRIC VIEW

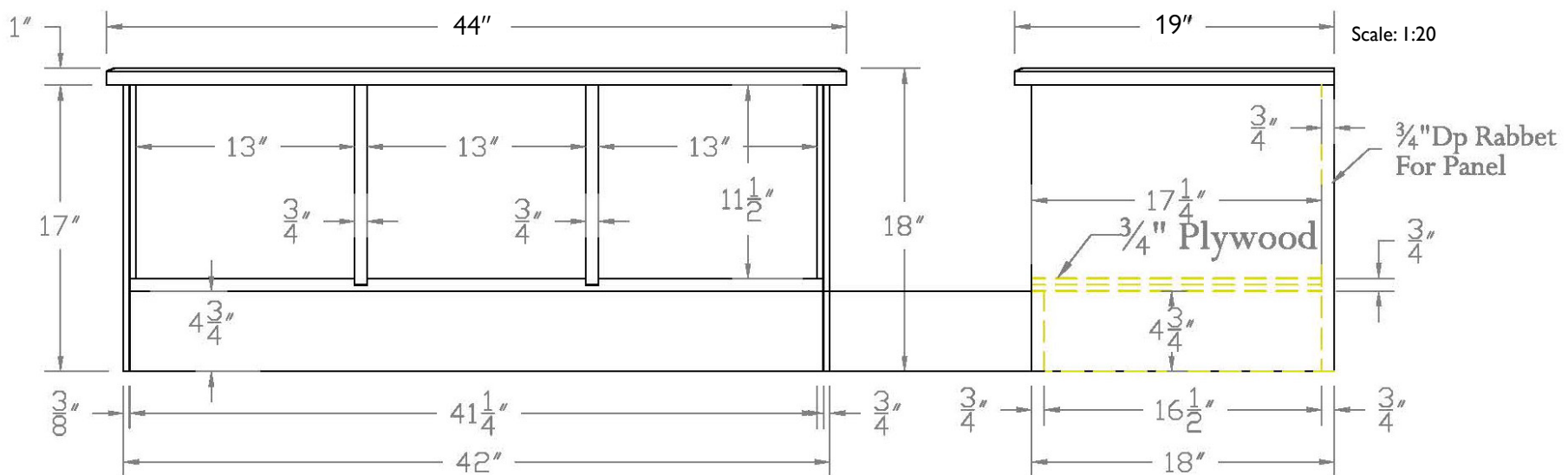



BUILD IT WITH BAIRD / MUDROOM BENCH

Step 4

Create rabbet cuts on the edge of your Nickel Gap wood. These cuts will allow for a gap between each piece without seeing the wall behind. Nail in place with a brad nailer and 1 1/2" nails.

If shiplap pieces don't match the height of the bench, join 2 pieces together to achieve a snug, secure fit.

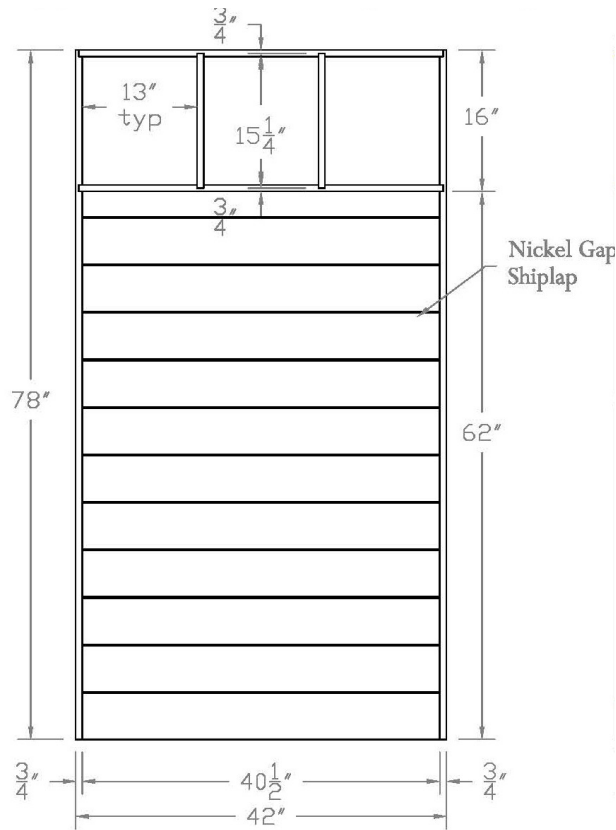

MATERIALS NEEDED			
Qty	Description	Material	T x W x L
1	Nickel Gap	Shiplap	3/4" x 41 1/4" x 77 1/4"

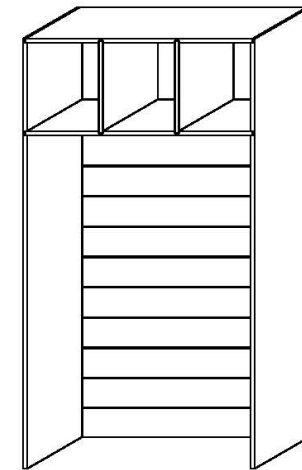
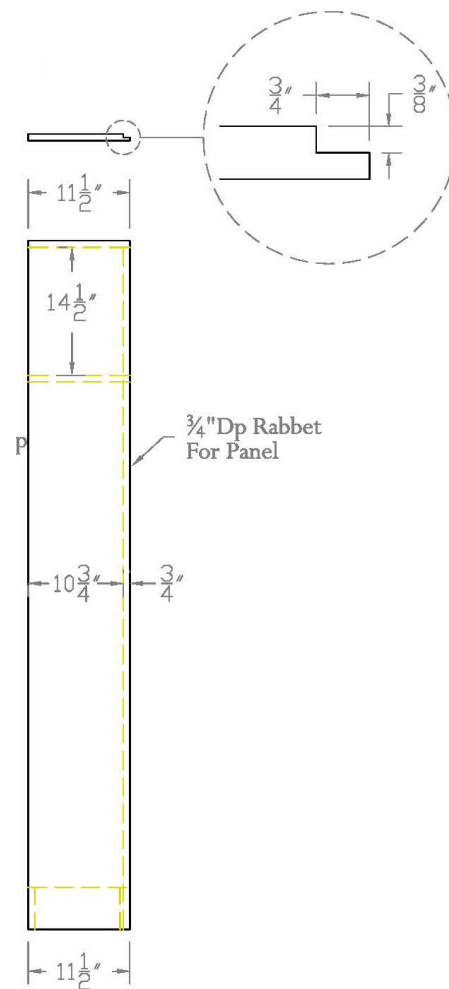

ISOMETRIC VIEW



BUILD IT WITH BAIRD / MUDROOM BENCH

Step 5

Measure and square up the face frame using 1x2 net, 1x4 for the stiles and rails, and 1x6 for the kickboard to cover the front of the bottom bench and top structure. Apply glue and face nail with a brad nailer using 1 1/2" nails.

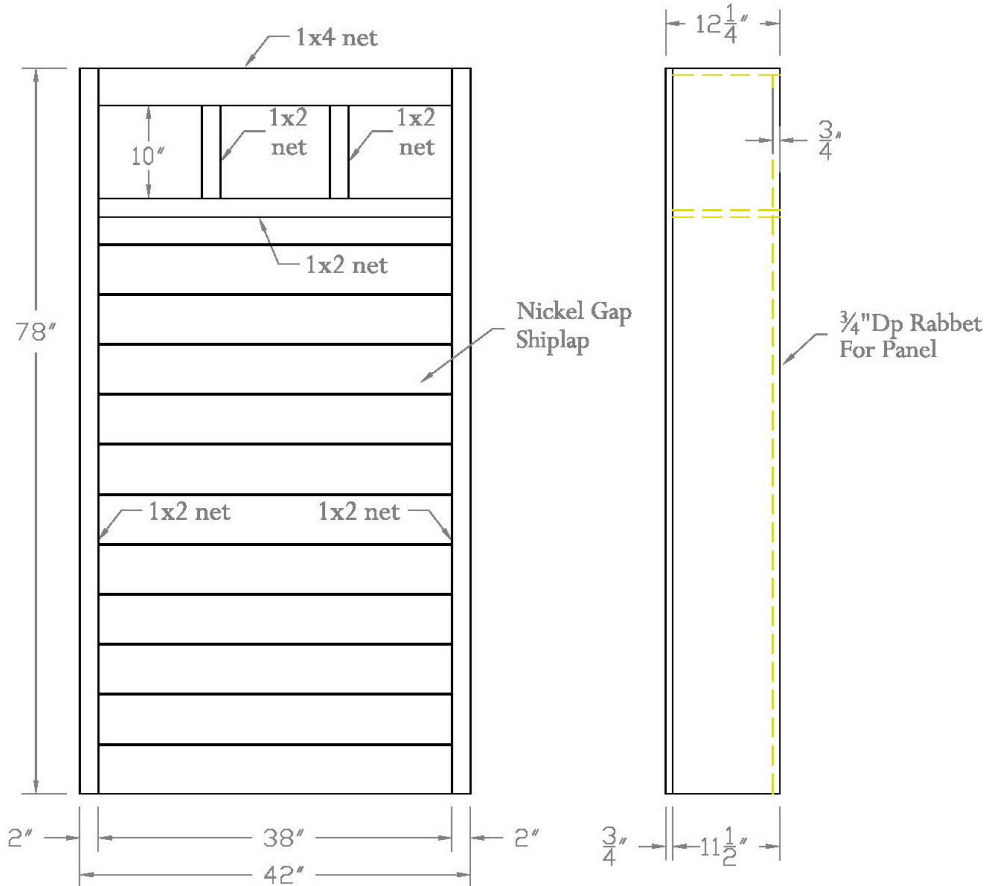

MATERIALS NEED		
Qty	Material	T x W x L
Face Frame Materials for Bottom Bench		
1	Poplar	1x6 x 42"
1	Poplar	1x2 net x 42"
4	Poplar	1x2 net x 9 1/2"
Face Frame Materials for Top Structure		
2	Poplar	1x2 net x 54"
1	Poplar	1x2 net x 38"
1	Poplar	1x4 net x 38"
2	Poplar	1x2 net x 10"
1	Character Grade White Oak Nickel Gap Shiplap	3/4" x 41 1/4" x 77 1/4"

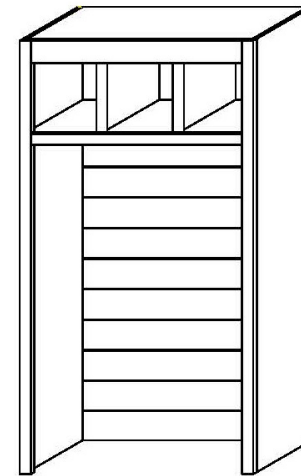

ISOMETRIC VIEW



Step 5

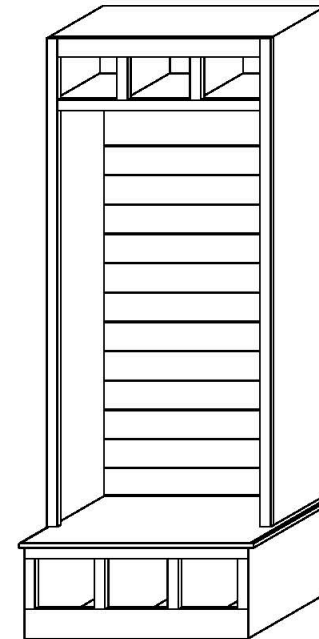
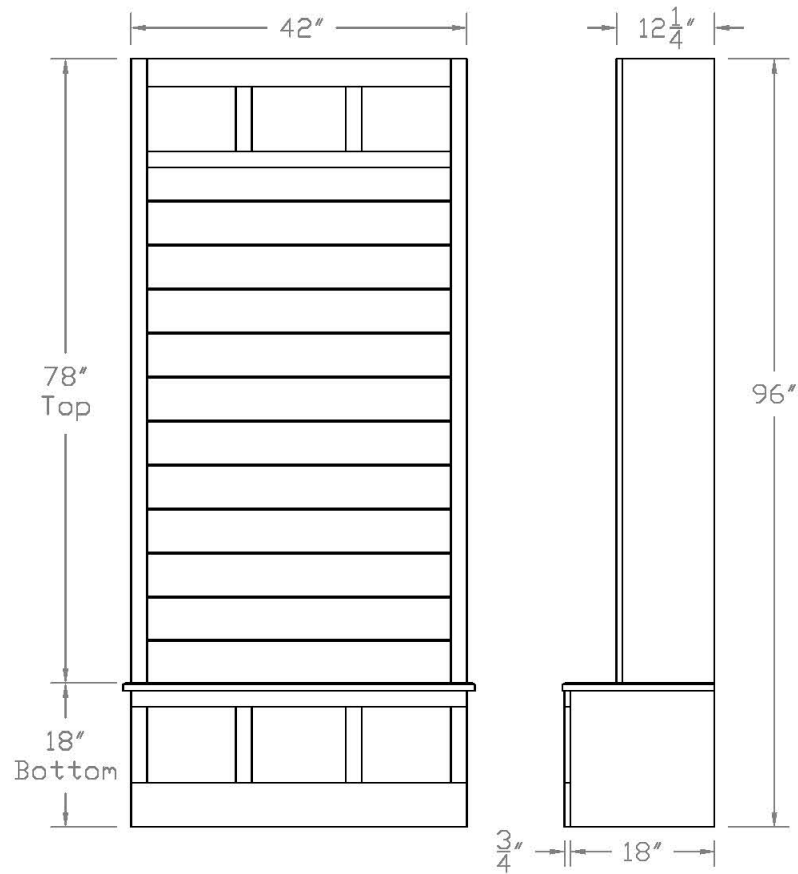

ISOMETRIC VIEW



BUILD IT WITH BAIRD / MUDROOM BENCH

Step 6

Choose baseboard and crown moulding to match the rest of your home. For our project, we chose Baird Brothers B303 and B211 for a combination of crown moulding and B211 for the baseboard.

MATERIALS NEEDED	
Description	Material
B303	Crown Moulding
B211	Baseboard

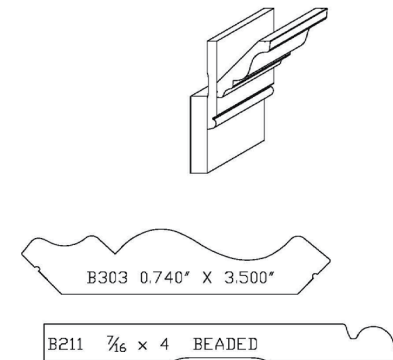
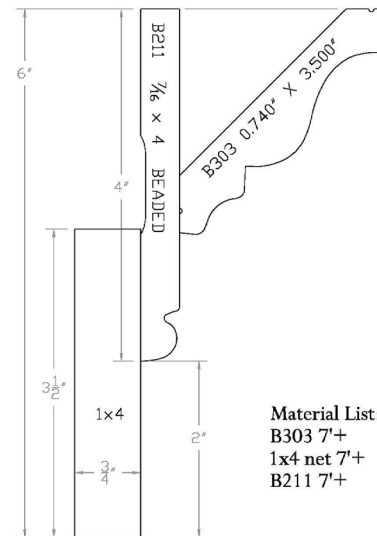
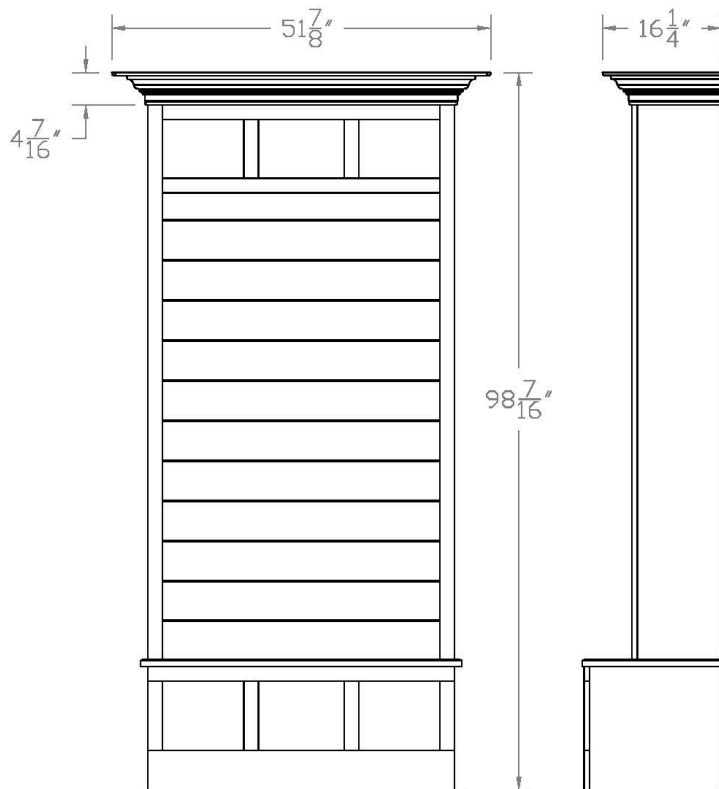

Material List:
 B303 7'+
 1x4 net 7'+
 B211 7'+



Step 7

MATERIALS NEEDED

Material	Size
Oak Half Round	1 ¼"

This mudroom bench is built in two pieces — the lower bench and the upper unit — which makes moving it in and out of your home (or to different rooms in your home) much easier. To attach the two units together, use a couple pieces of 1 ¼" oak half-round to act as support cleats on the back of the unit.

After drilling pilot holes, use 1 ½" screws to adhere the half round to the back, spanning across both the top and bottom units.

Choose coat hooks to match the rest of your home and install them on the shiplap wall in your preferred design or style.

